

Accuracy Check
Alco-Sensor III
 Using .038 Alcohol Gas Tank

Step 1: Attach Regulator Follow instructions on the Alcohol Gas Tank to attach the regulator.

Step 2: Purge Regulator by pressing button/valve on regulator for approximately 3-4 seconds before running your first accuracy check of the day.

Step 3: Attach mouthpiece to the regulator tubing.

Step 4: Check temperature of the Alco-Sensor by pressing READ while holding down the SET button. The temperature should read between 15c and 36c. Release the READ button.

Step 5: Perform Blank by pressing only the READ button, allowing the SET button to pop up, drawing fresh air from the room. Observe .000 in the dim mode and then in the bright display mode before continuing on with the test procedure.

Step 6: Zero Check If .000 is not seen in the bright mode, depress SET button and recheck in one minute.



Step 7: Reset Press the SET button.



Step 8: Attach Alco-Sensor

Carefully attach Alco-Sensor to mouth-piece assembly.



Step 9: Standard Value Review the elevation chart on the tank to calculate the alcohol concentration for the tank at your elevation. The value can also be determined from an appropriate True-Cal device.



Step 10: Sample Gas Press regulator button for 6 seconds. On the 4th second of the 6-second count, press the READ button. (NOTE: The gas must be flowing through the mouthpiece when the READ button is depressed).

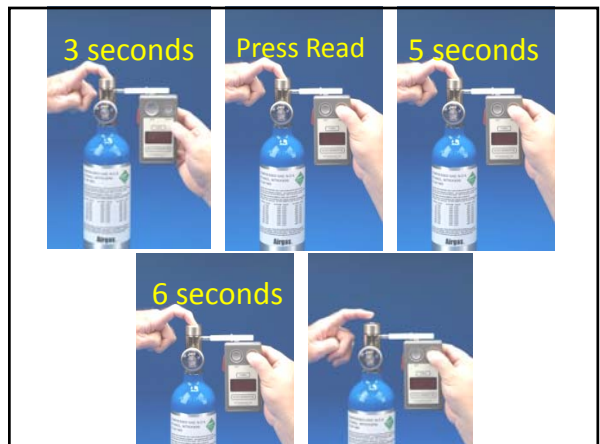

11: Observe Reading Detach the mouthpiece assembly from the Alco-Sensor and observe the reading until it becomes stable and bright.



Step 12: Interpret Results

Results within +/- .005 (or the acceptable tolerance specified by your agency) of the value of the Alcohol Gas Tank are acceptable. The Alco-Sensor III is reading accurately.

Results that are not within +/- .005 out of acceptable tolerance.

See the following examples.

Acceptable Tolerance

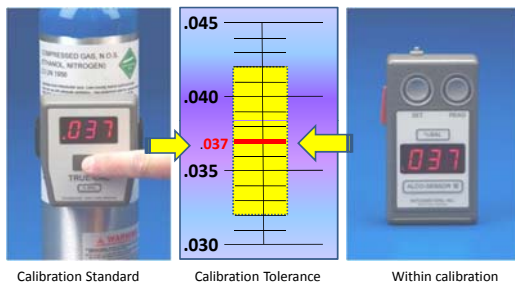

Acceptable Tolerance

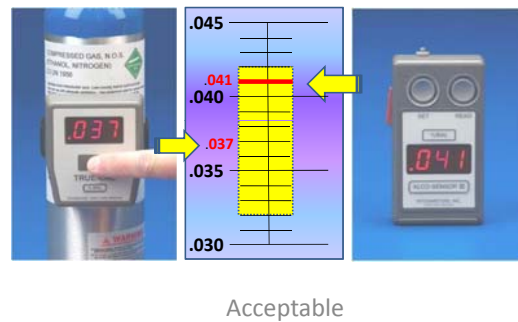

Acceptable Tolerance

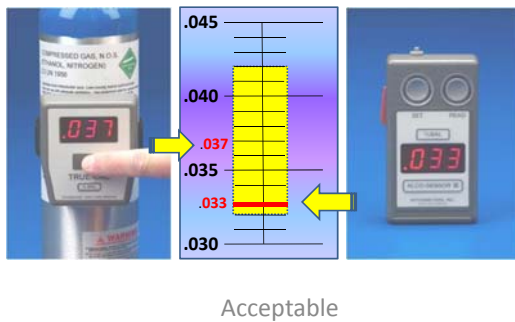

Not Acceptable Tolerance

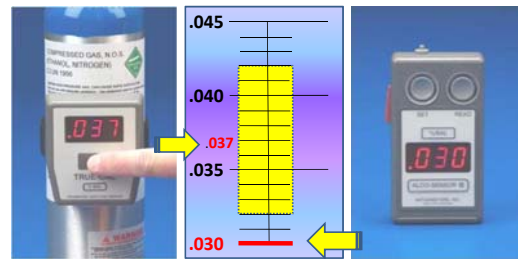

⊘ Not Acceptable Tolerance

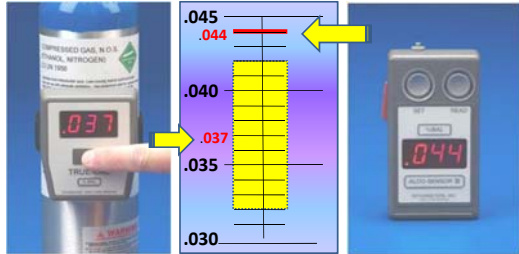

Not Acceptable Tolerance:

If the reading is not within acceptable tolerance (greater than +/- .005 from the Alcohol Gas Tank value), the operator must perform a Calibration Adjustment.

See separate instructions for performing a Calibration Adjustment.

Step 13: Record Results

Record every Accuracy Check result in calibration log to document the accuracy of the Alco-Sensor.

Final Step: When finished or not in use, be sure SET button is pressed down.



For technical assistance and to order calibration supplies:

AlcoPro, Inc.
800 227-9890
www.alcopro.com