

Accuracy Check: Alco-Sensor IV with Memory

Using a .038 Alcohol Gas Tank and 1.5 liter-per-minute regulator.



Step 1: Attach Regulator

Follow instructions on the Alcohol Gas Tank to attach the regulator.



Step 2: Purge Regulator by pressing button/valve on regulator for approx. 8-10 seconds before running your first accuracy check of the day.



Step 3: Determine Gas Value by reviewing the elevation chart on the tank to calculate the alcohol concentration for the 0.038 tank at your elevation. The value can also be determined more easily by utilizing a True-Cal device.



Step 4: Start Accuracy Check Procedure

Turn the instrument on by securely inserting a disposable mouthpiece into the Alco-Sensor IV with Memory.



Step 4 cont'd: Start Accuracy Check

Once the mouthpiece is inserted, the temperature, date, time and the current 4-digit test # will scroll across the display.



Step 4 cont'd: Start Accuracy Check

After the 4-digit test # has appeared twice, the display will flash "<" ">", and then "Blnk" while the instrument performs an automatic Air Blank. If the instrument is free of alcohol, it should read "0.00" for a few seconds. The display will then flash "Test".

**Step 4 cont'd: Start Accuracy Check**

While the display is flashing "Test", press & hold the **RECALL** button until "CHK?" is displayed.

Once "CHK?" is displayed, press & release the **MANUAL** button to display "CHECK".

"CHECK" indicates the instrument is in Accuracy Check mode.

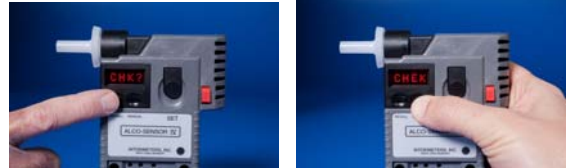
**Step 5: Attach Alco-Sensor IV with Memory to regulator**

Securely attach the instrument via the mouthpiece to the tube on the tank regulator.

**Step 6: Start Gas Flow**

Press the regulator button for 7 seconds.

On the 5th second, press the **MANUAL** button to take the gas sample.

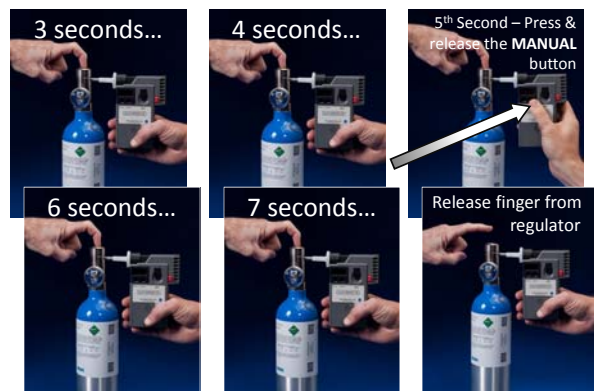
**Step 6 cont'd: Start Gas Flow****Additional Note on Gas Flow**

NOTE 1: Gas must be flowing through the mouthpiece during the entire 7-second process, therefore continue pressing the tank regulator button for another 2 seconds **AFTER** you press & release the **MANUAL** button during the 5th second.

Step 7: Observe Reading

- Once the sample has been taken, the instrument will momentarily flash “<” and “>”, then will display the 3-digit reading for several seconds. Record this reading.
- The display will then flash “.” across the left and right edges of the screen, indicating the instrument is sending the results to the printer (if connected).
- Once this has been completed, the instrument will flash “SET”. Press the **SET** button, then press the Red Release button to eject the mouthpiece, which will turn off the instrument.

Step 8: Interpret Results

Results within +/- .005 of the elevation-adjusted value of the Alcohol Gas Tank are acceptable.

The Alco-Sensor IV with Memory is reading accurately.

(see next 3 slides for acceptable readings)

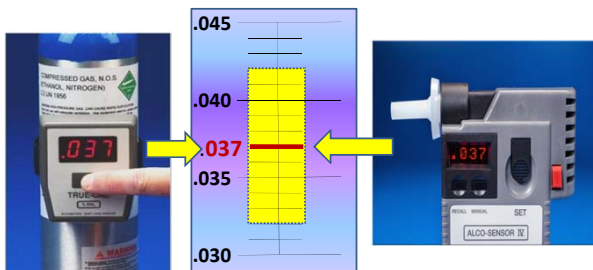
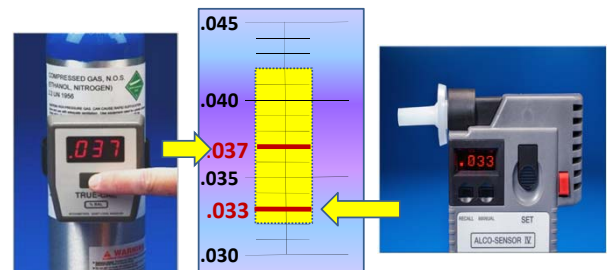
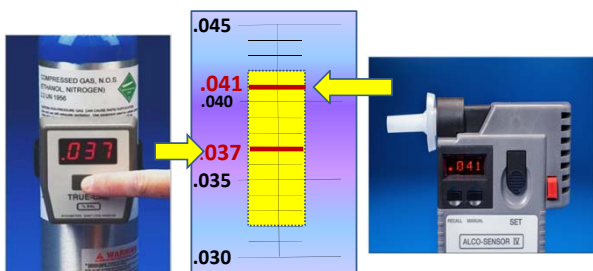
Acceptable Tolerance**Acceptable Tolerance****Acceptable Tolerance****Step 8 cont'd: Interpret Results**

Results that are **NOT** within +/- .005 of the elevation-adjusted value are out of acceptable tolerance.

The Operator must perform a Calibration Adjustment.

(see next 2 slides for unacceptable readings)

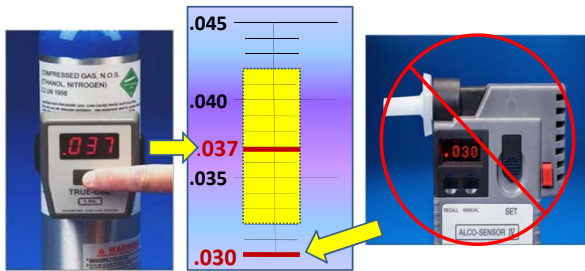
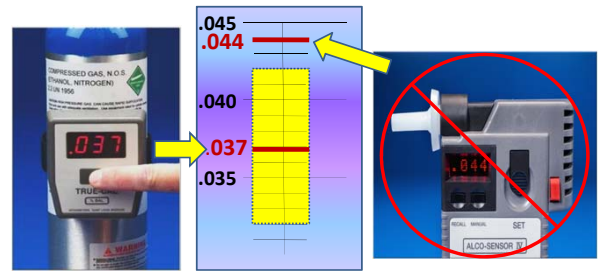
NOT Acceptable !!**NOT Acceptable !!****Step 9: Record Results**

Record every Accuracy Check result in a Calibration Log to document the accuracy of the Alco-Sensor IV with Memory.

For technical assistance and to order calibration supplies:

AlcoPro, Inc.
800 227-9890
www.alcopro.com